

- NOTES:**
- FOR ACCURATE PWD DATA, CONTACT RIGHT OF WAY ENGINEERING AT THE DISTRICT OFFICE.
 - FOR DETAILS NOT SHOWN, SEE CONSTRUCTION DETAILS.
 - SEE UTILITY SHEETS FOR UTILITY DETAILS.

LEGEND

BIORETENTION CELL (SWALE), SEE DRAINAGE DETAILS

SM Sta 10+00 to 17+50
 0.42' Replace AC Surfacing

SM Sta 17+50 to 20+50
 0.60' HMA (Type A)
 0.60' CL2AB
 Tensar NX850 (1682 Sq Yd)

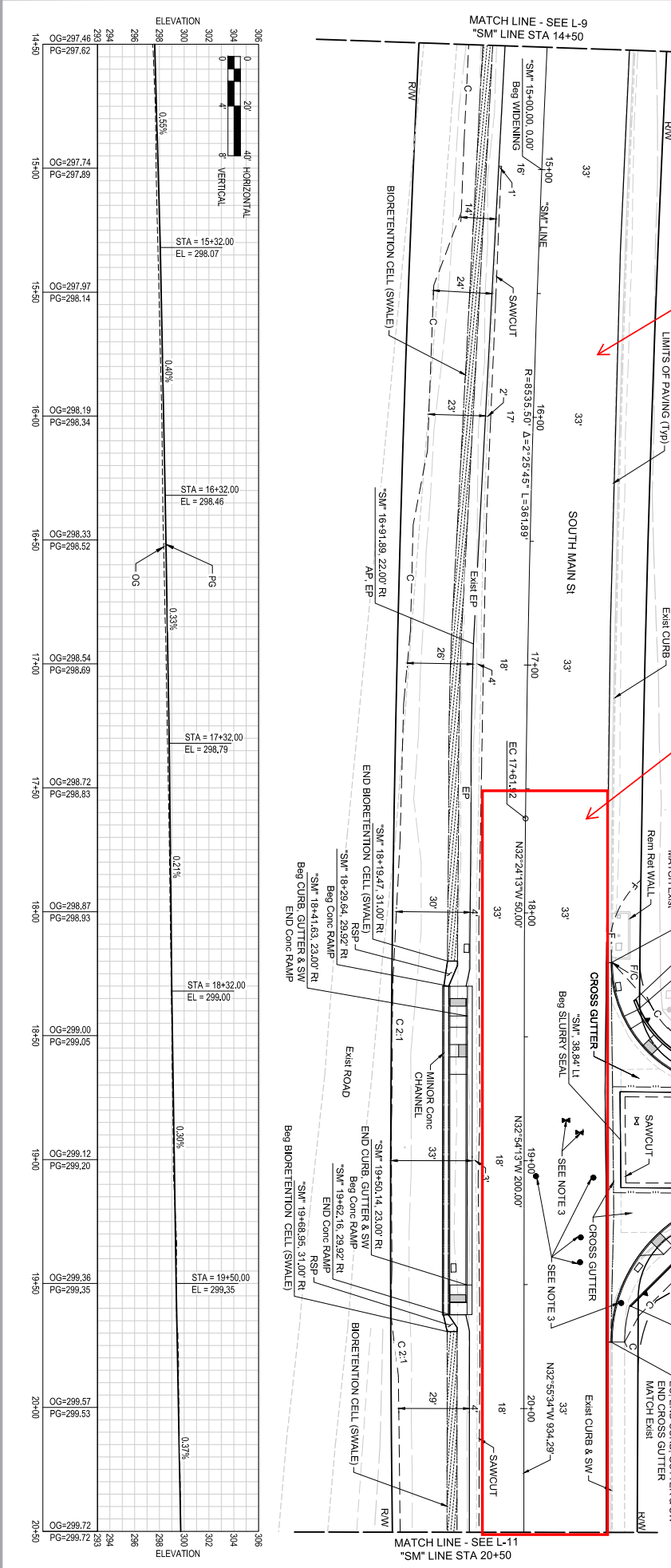

<p>TEHAMA COUNTY DEPARTMENT OF PUBLIC WORKS</p> <p>9380 SAN BENITO AVE GERBER, CA 96035 530-382-1462</p>		<p>Bar is not link on original issue sheet</p>	
<p>TEHAMA COUNTY DEPARTMENT OF PUBLIC WORKS</p> <p>RECONSTRUCTION</p> <p>12/21/2023</p>		<p>1" = 20'</p>	

- NOTES:**
- FOR ACCURATE PWD DATA, CONTACT RIGHT OF WAY ENGINEERING AT THE DISTRICT OFFICE.
 - FOR DETAILS NOT SHOWN, SEE CONSTRUCTION DETAILS.
 - SEE UTILITY PLANS FOR UTILITY DETAILS.

LEGEND

BIORETENTION CELL (SWALE), SEE DRAINAGE DETAILS

SM Sta 20+50 to 26+50
0.60' HMA (Type A)
Tensar NX850 Only Where Needed

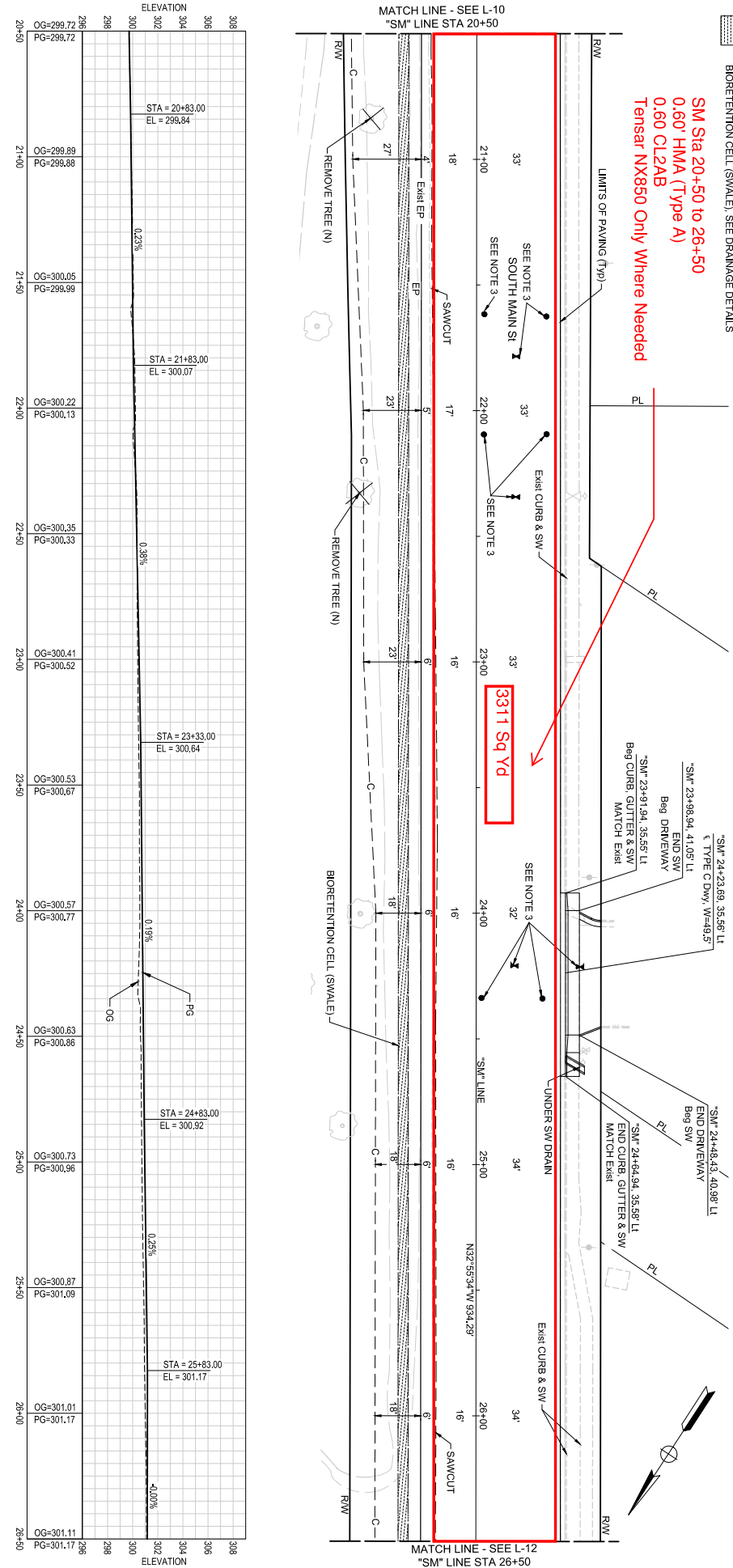

<p>Author: A. ARROWELL Designer: A. ARROWELL Designer: M. SIEGLER Designer: M. SIEGLER Designer: D. REIS</p>	<p>Checked: Approved Project Manager: M. SIEGLER Project Director: D. REIS</p>	<p>TEHAMA COUNTY DEPARTMENT OF PUBLIC WORKS 9380 SAN BENTO AVE. GERBER, CA 96055 530-385-1462</p>	<p>Bar is one inch on original scale sheet</p>			<p>Contractor of Record Conditions of Use This document and the data and designs incorporated herein are the property of GHD and are to be used only for the project and location identified herein. No part of this document may be reproduced or transmitted in any form or by any means, electronic or mechanical, including photocopying, recording, or by any information storage and retrieval system, without the prior written permission of GHD.</p>	<p>Client: TEHAMA COUNTY DEPARTMENT OF PUBLIC WORKS Project: SOUTH MAIN STREET (99W) RECONSTRUCTION</p>	<p>Sheet L-1 26 of 122</p>
<p>Scale: 1" = 20'</p>	<p>Date: 12/21/2023</p>	<p>Project No: 11184570</p>	<p>Scale: 1" = 20'</p>	<p>Date: 12/21/2023</p>	<p>Scale: 1" = 20'</p>	<p>Date: 12/21/2023</p>	<p>Scale: 1" = 20'</p>	<p>Date: 12/21/2023</p>

- NOTES:**
- FOR ACCURATE PWD DATA, CONTACT RIGHT OF WAY ENGINEERING AT THE DISTRICT OFFICE.
 - FOR DETAILS NOT SHOWN, SEE CONSTRUCTION DETAILS.
 - SEE UTILITY PLANS FOR UTILITY DETAILS.

LEGEND

BIORETENTION CELL (SWALE), SEE DRAINAGE DETAILS

SM Sta 26+50 to 30+80
 0.60' HMA (Type A)
 0.60' CL2AB
 Tensar NX850 Only Where Needed

SM Sta 30+80 to 32+50
 0.60' HMA (Type A)
 0.80' CL2AB
 Tensar NX850 (830 Sq Yd)

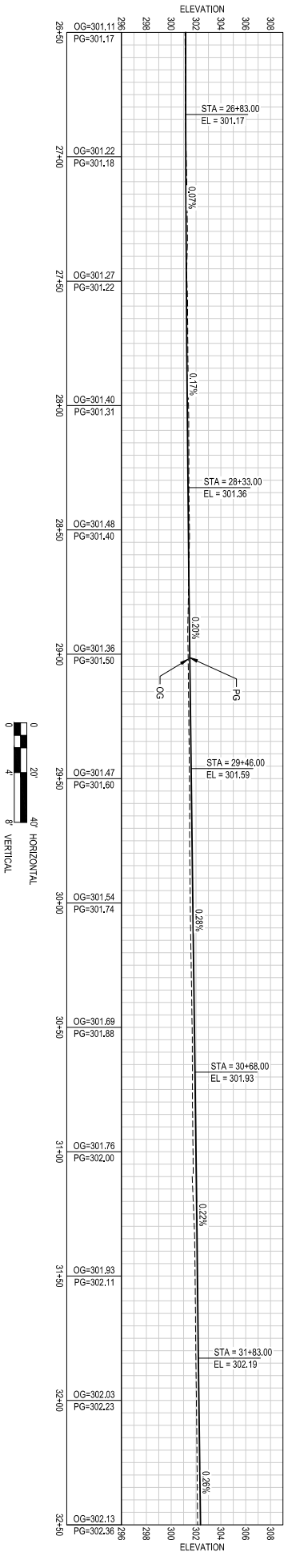
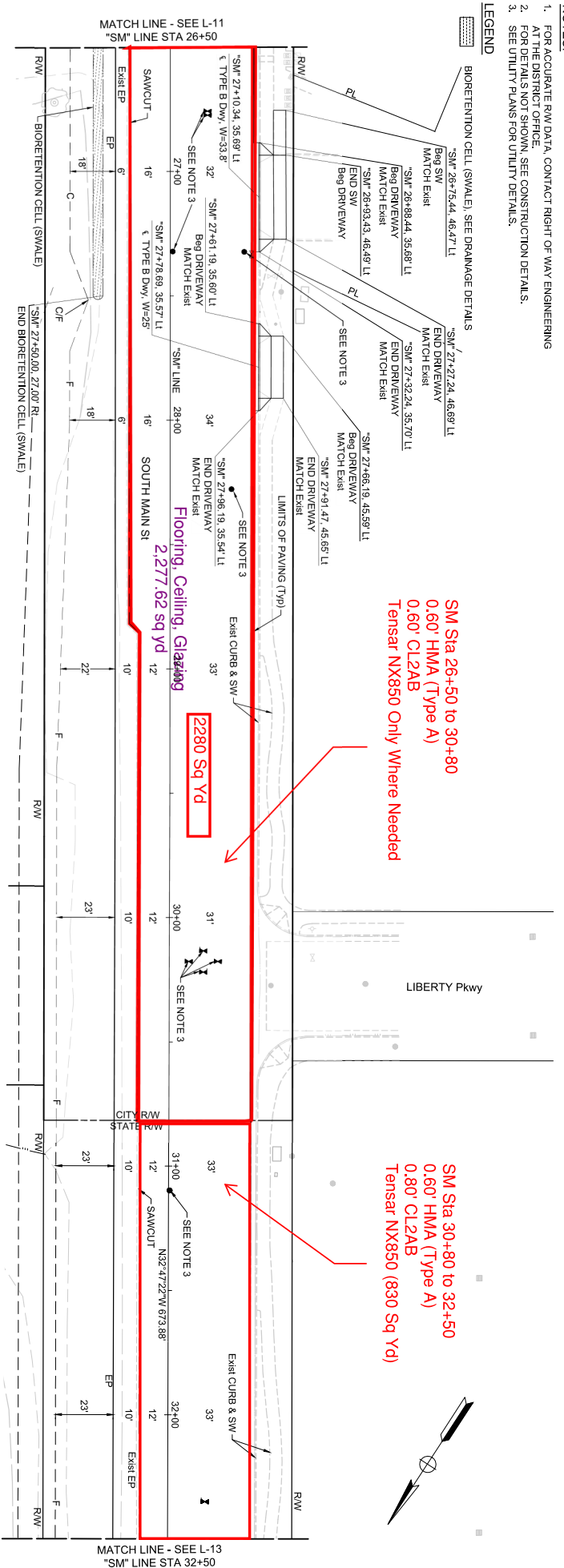

<p>TEHAMA COUNTY DEPARTMENT OF PUBLIC WORKS</p> <p>9380 SAN BENITO AVE GERBER, CA 96035 530-385-1462</p>			<p>Bar is one inch on original size sheet</p>
<p>Author: A. SROWEIL Designer: A. SROWEIL</p>	<p>Checked: Approved Date: _____</p>		
<p>Project: TEHAMA COUNTY DEPARTMENT OF PUBLIC WORKS SOUTH MAIN STREET (99W) RECONSTRUCTION</p>			<p>Conditions of Use: This document and the data and designs incorporated herein are the property of GHD and are to be used only for the project and location specified. No part of this document may be reproduced or transmitted in any form or by any means electronic or mechanical, including photocopying, recording, or by any information storage and retrieval system, without the prior written permission of GHD.</p>
<p>Project No: 11184570 Date: 12/21/2023</p>	<p>Scale: 1" = 20'</p>		

