

COUNTY OF TEHAMA

Department of Agriculture Division of Animal Services

1830 Walnut Street; PO Box 38; Red Bluff, California 96080
Ph. (530) 527-3439

Thomas Moss
Director – Animal Services
Email: tmoss@tehama.gov

Christine McClintock
Manager – Animal Care Center
Email: cmccclintock@tehama.gov

February 11, 2025

Oak Tree Furniture

Dear Oak Tree Furniture,

On behalf of the Division of Animal Services, we are extremely grateful! Your generous donation of the 10x12 St Ranch shed to the Animal Care Center on February 7, 2025 will make a tremendous difference.

Your contribution allows us to continue our mission to practice and promote responsible compassionate care of all animals, both in our care and in the community we serve.

Sincerely,

Thomas Moss
Director of Animal Services

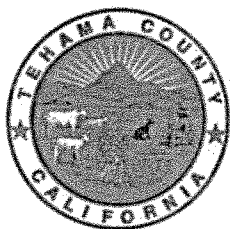

Tehama County Donation Receipt

Department of Agriculture / Division of Animal Services
PO Box 38 • Red Bluff, California 96080 • (530)527-3439

DONOR INFORMATION:

Name Oak Tree Furniture Date _____

DONATION INFORMATION:

Type of Donation: ☐ Money ☒ Other

Items Donated: 10x12 St Ranch Shed.

☐ Amount of Monetary Donation _____ Receipt Number Issued _____

OR

☒ Value of Property: 4,160

Person Receiving Donation: Shannon

This paperwork to be submitted to Thomas Moss, Director of Animal Services, by the next business day.

OFFICE USE ONLY

Processed by: _____ Date: _____

SEQUOIA SHEDS

www.sequoiasheds.com

Local

Quality

Sheds

Theodore Yoder

Phone: 530-840-4465

www.sequoiasheds.com

theodore@sequoiasheds.com

13481 Baker Road

Red Bluff, CA 96080

#

Date: 2/7 Due Date: 2/10-14

Quotes good for 21 days

Order ☒ Quote ☐ Salesman: Theodore

For delivery scheduling questions, please call Virgil at (530) 737-8780. Expect a call the week before your due date to schedule your delivery. For other questions, please call (530) 840-4465.

Customer Information

Name: Tenama County Animal Care Center

Address: 1830 Walnut St.

City: Red Bluff CA Zip: 96080

Email: swineson@tenama.gov

Phone #1: 530-527-3434

Phone #

How did you find out about us?

Building Type

Size: 10x12 Style: St-Ranch

Premium 10Yr Warranty ☐ Standard 3 Year Warranty ☒

Doors: 4 LH ☐ RH ☒

Exterior

Main paint color: Light Grey

Trim paint color: "

No paint ☐

Roof type: Metal

Roof color: white

Delivery Information

Prefabricated ☒ Onsite ☐

Level pad ☒ Extra blocks ☐

Generator needed ☐ Display ☒

Notes: 3 year warranty
Deliver from 8 to 5

Building Sketch

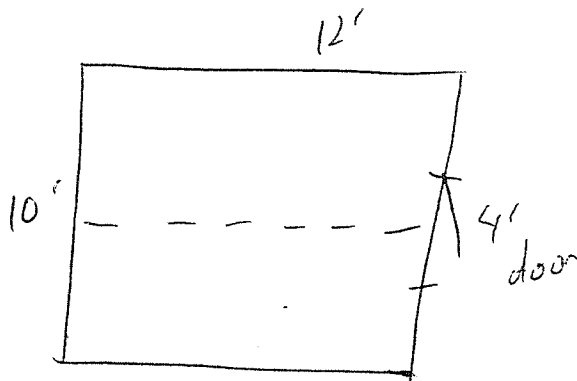

Qty	Options	Base Price	
			4000
	Cash discount		-120
		Subtotal	3880.00
		Tax	281.30
		Total	4161.30
		Down Payment	4160.00
		Balance due upon delivery	0.00
		Paid in full 2/7/25	
		Thank You	

In some areas, building codes or covenant restrictions regulate portable buildings. I assume responsibility to comply with such regulations if they exist. I agree to provide a level area for the shed (within 6 inches of level). I understand that shed settling after delivery, due to soft ground, is not the responsibility of Sequoia Sheds. By signing below, I indicate that I have reviewed and am satisfied with the price and design of my shed, agree to the terms above, and that any changes in design or options may result in extra charges.

Signature: _____

Date: _____