

TEHAMA COUNTY – DEPARTMENT OF PUBLIC WORKS
CONTRACT CHANGE ORDER MEMORANDUM

DATE: August 8, 2024

DC-CEM-4903 4903 (REV 06/2016)

TO: Jon McClain			FILE E.A	Tehama County 99W & South Main Street Project County Project Number: 2708181 Federal Aid Project RPSTPL 5908(100) Caltrans Contract Number: 02-IJ6204
FROM: James Smolenski				
CCO NO. Eleven 11	SUPPLEMENT NO.	CATEGORY CODE:	CONTINGENCY BALANCE (Including this change): Caltrans \$758,399.74 / City \$522,698.36 / County \$619,629.72	
\$43,000.00		INCR <u> X </u> DECR	HEADQUARTERS APPROVAL REQUIRED? YES NO <u> X </u>	
SUPPLEMENTAL FUNDS PROVIDED \$ 0			IS THIS REQUEST IN ACCORDANCE WITH ENVIRONMENTAL DOCUMENTS? YES <u> X </u> NO	

THIS CHANGE ORDER PROVIDES FOR:

At Location 4, install the added drainage system at “SM” station 39+71 to 40+32 and embankment according to the RFI #31 Additional Info Exhibit 1 sheet attached as Sheet No. 2 of this change.

Reason for Change:

The plans show to construct new sidewalk from “SM” station 40+23 TO 39+00. However, there is insufficient embankment width available to construct the planned sidewalk section without encroaching into the flowline of the adjacent roadside ditch. In response to the Contractor’s RFI No. #31 and additional original ground topo information, the Designer included the addition of 60 LF of 24" RCP and 2 additional concrete flared end sections.

Method of Payment:

Increase in Bid Items at Bid Item Prices. Total estimated item increase = \$43,000.00

Time Adjustment:

There will be no time adjustment for this change.

CONCURRED BY:		ESTIMATE OF COST	
RESIDENT ENGINEER: James M. Smolenski	DATE: 9/8/2024	ITEMS	THIS REQUEST TOTAL TO DATE \$43,000.00 \$43,000.00
COUNTY PROJECT MANAGER: Jon McClain	DATE:	FORCE ACCOUNT	
COUNTY PUBLIC WORKS DIRECTOR: James N. Simon	DATE:	AGREED PRICE	
CITY OF RED BLUFF PUBLIC WORKS: R. Scott Miller	DATE:	ADJUSTMENT	
CALTRANS OVERSIGHT ENGINEER: Kyle Higgins	DATE: 10/15/24	TOTAL	\$43,000.00 \$43,000.00
ENGINEER OF RECORD: Meghan Sigler	DATE:	FEDERAL PARTICIPATION	
		<input checked="" type="checkbox"/> PARTICIPATING <input type="checkbox"/> PARTICIPATING IN PART <input type="checkbox"/> NONE <input type="checkbox"/> NON-PARTICIPATING (Maintenance) <input type="checkbox"/> NON-PARTICIPATING	
		FEDERAL SEGREGATION (If more than one funding source or P.I.P type)	
		CCO FUNDED PER CONTRACT <input checked="" type="checkbox"/> CCO FUNDED AS FOLLOWS <div style="text-align: right;">PERCENT</div>	
		Caltrans	100%
		City of Red Bluff	0%
		Tehama County	0%

CONTRACT CHANGE ORDER

CEM-4900 (OLD HC-5 REV. 9/97) CT# 7541-3501-0

Change Requested by: Engineer Contractor

CCO NUMBER Elevcn (11)	SUP NUMBER	CONTRACT NO. Tehama County: 2708181 Caltrans: 02-IJ6204	ROAD 99W / S. Main Street	FEDERAL NUMBER(S) RPSTPL 5908(100)
---------------------------	------------	---	------------------------------	---------------------------------------

TO **S T Rhoades Construction** CONTRACTOR

*You are directed to make the following changes from the plans and specifications or do the following described work not included in the plans and specifications for this contract. **NOTE: This change order is not effective until approved by the Engineer.***

Description of work to be done, estimate of quantities and prices to be paid. (Segregate between additional work at contract price, agreed price and force account.) Unless otherwise stated, rates for rental of equipment cover only such time as equipment is actually used and no allowance will be made for idle time. The last percentage shown is the net accumulated increase or decrease from the original quantity in the Engineer's Estimate

At Location 4, install the added drainage system at "SM" station 39+71 to 40+32 and embankment according to the RFI #31 Additional Info Exhibit 1 sheet attached as Sheet No. 2 of this change.

INCREASE IN ITEM AT ITEM PRICE

Item 64 24" REINFORCED CONCRETE PIPE **60.0 LF** (+300%) @ \$600/LF = **\$36,000.00** (+300.00%)
 Item 65 18" CONCRETE FLARED END SECTION **2 EA** (+200%) @ \$3,500/EA = **\$7,000.00** (+200.00%)

Total estimated item increase = \$43,000.00

In accordance with Section 9-1.06B, "Increases of More Than 25 Percent," of the Standard Specifications, you will receive the following payment adjustments: None.

Net cost for this change = \$43,000.00

There will be no time adjustment as a part of this change.

Estimated Cost: \$43,000.00

Decrease Increase

By reason of this order the time of completion will be adjusted as follows: None

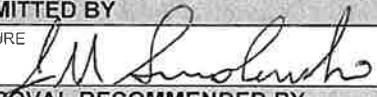
SUBMITTED BY		
SIGNATURE 	James M. Smolenski, Resident Engineer	DATE 8/16/2024
APPROVAL RECOMMENDED BY		
SIGNATURE	John McClain, County Project Manager	DATE
ENGINEER APPROVAL BY		
SIGNATURE	James N. Simon, Director	DATE

We the undersigned contractor, have given careful consideration to the change proposed and agree, if this proposal is approved, that we will provide all equipment, furnish the materials, except as may otherwise be noted above, and perform all services necessary for the work above specified, and will accept as full payment therefor the prices shown above. **NOTE: If you, the contractor, do not sign acceptance of this order, your attention is directed to the requirements of the specification as to proceeding with the ordered work and filing a written protest within the time therein specified.**

CONTRACTOR ACCEPTANCE BY		
SIGNATURE 	(PRINT NAME & TITLE) Brian Zarr, Project Manager	DATE 10-24-24

NOTES:

- 1 CONTRACTOR TO FIELD VERIFY EXACT FLOWLINE OF DITCH AND ADJUST FLOWLINE OF PIPE AS NECESSARY
- 2 FOR CURB, GUTTER AND SIDEWALK ELEVATIONS SEE SHEET C-18

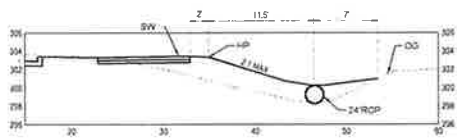
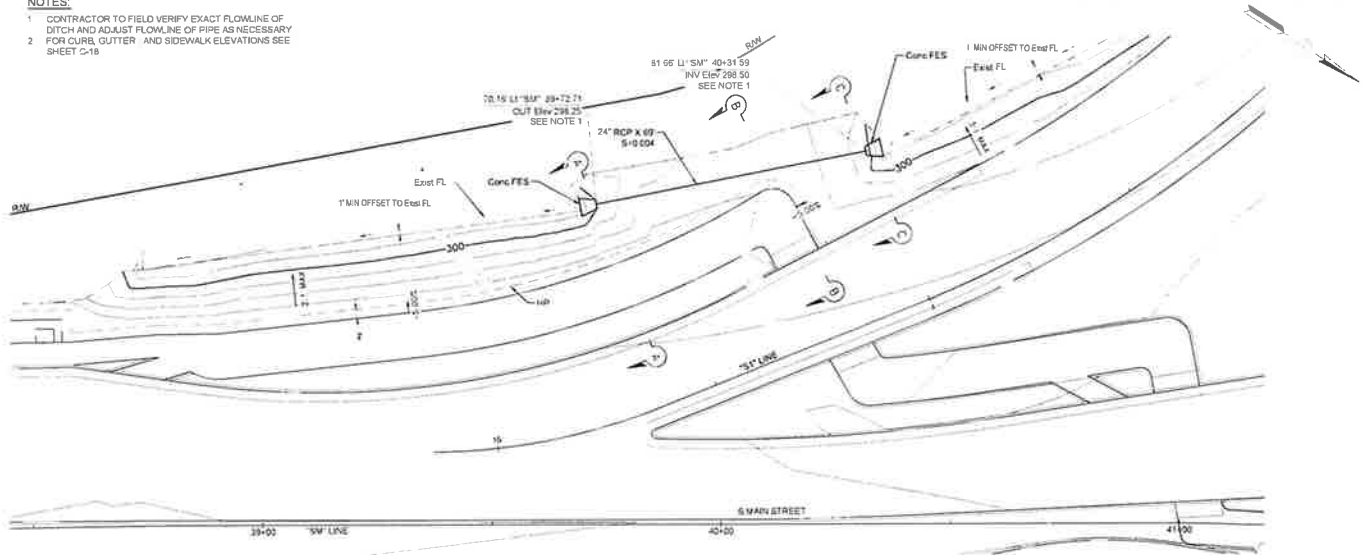

SECTION A-A
H SCALE: 1" = 5'
V SCALE: 1" = 5'

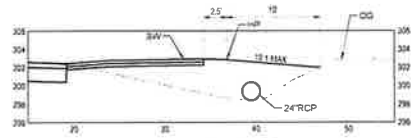

SECTION B-B
H SCALE: 1" = 5'
V SCALE: 1" = 5'

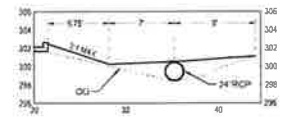

SECTION C-C
H SCALE: 1" = 5'
V SCALE: 1" = 5'

<table border="1" style="width: 100%; border-collapse: collapse;"> <tr><td style="font-size: 8px;">DATE</td><td style="font-size: 8px;">DRAWN BY</td><td style="font-size: 8px;">CHECKED BY</td><td style="font-size: 8px;">DATE</td></tr> <tr><td style="font-size: 8px;"> </td><td style="font-size: 8px;"> </td><td style="font-size: 8px;"> </td><td style="font-size: 8px;"> </td></tr> <tr><td style="font-size: 8px;"> </td><td style="font-size: 8px;"> </td><td style="font-size: 8px;"> </td><td style="font-size: 8px;"> </td></tr> <tr><td style="font-size: 8px;"> </td><td style="font-size: 8px;"> </td><td style="font-size: 8px;"> </td><td style="font-size: 8px;"> </td></tr> </table>	DATE	DRAWN BY	CHECKED BY	DATE													<p>TEHAMA COUNTY DEPARTMENT OF PUBLIC WORKS 9380 SAN BONITO AVE. GERBER, CA 95925 530-325-1462</p>				<p>TEHAMA COUNTY DEPARTMENT OF PUBLIC WORKS SOUTH MAIN STREET (SSW) RECONSTRUCTION</p>	<p>RFI # 31 ADDITIONAL INFO FOR "SM" 39+00 TO 40+23</p>
DATE	DRAWN BY	CHECKED BY	DATE																			
<table border="1" style="width: 100%; border-collapse: collapse;"> <tr><td style="font-size: 8px;">PROJECT NO.</td><td style="font-size: 8px;">11184075</td></tr> <tr><td style="font-size: 8px;">SHEET NO.</td><td style="font-size: 8px;">1092204</td></tr> <tr><td style="font-size: 8px;">DATE</td><td style="font-size: 8px;">8" x 12"</td></tr> </table>	PROJECT NO.	11184075	SHEET NO.	1092204	DATE	8" x 12"						<table border="1" style="width: 100%; border-collapse: collapse;"> <tr><td style="font-size: 8px;">SCALE</td><td style="font-size: 8px;">1" = 5'</td></tr> </table>	SCALE	1" = 5'								
PROJECT NO.	11184075																					
SHEET NO.	1092204																					
DATE	8" x 12"																					
SCALE	1" = 5'																					